

# 2935 Conroy Road

*Ottawa, ON*



## Multi-tenanted industrial building.

Located just 3km west of HWY 417, the Property boasts easy access to major shipping routes.

### Unit 120

27,191 SF

- Available immediately
- Open warehouse space
- 22.5 ft. ceilings
- Air-conditioned
- 2 OH doors to loading deck (dock-level)
- Net rent: \$10.00 per SF

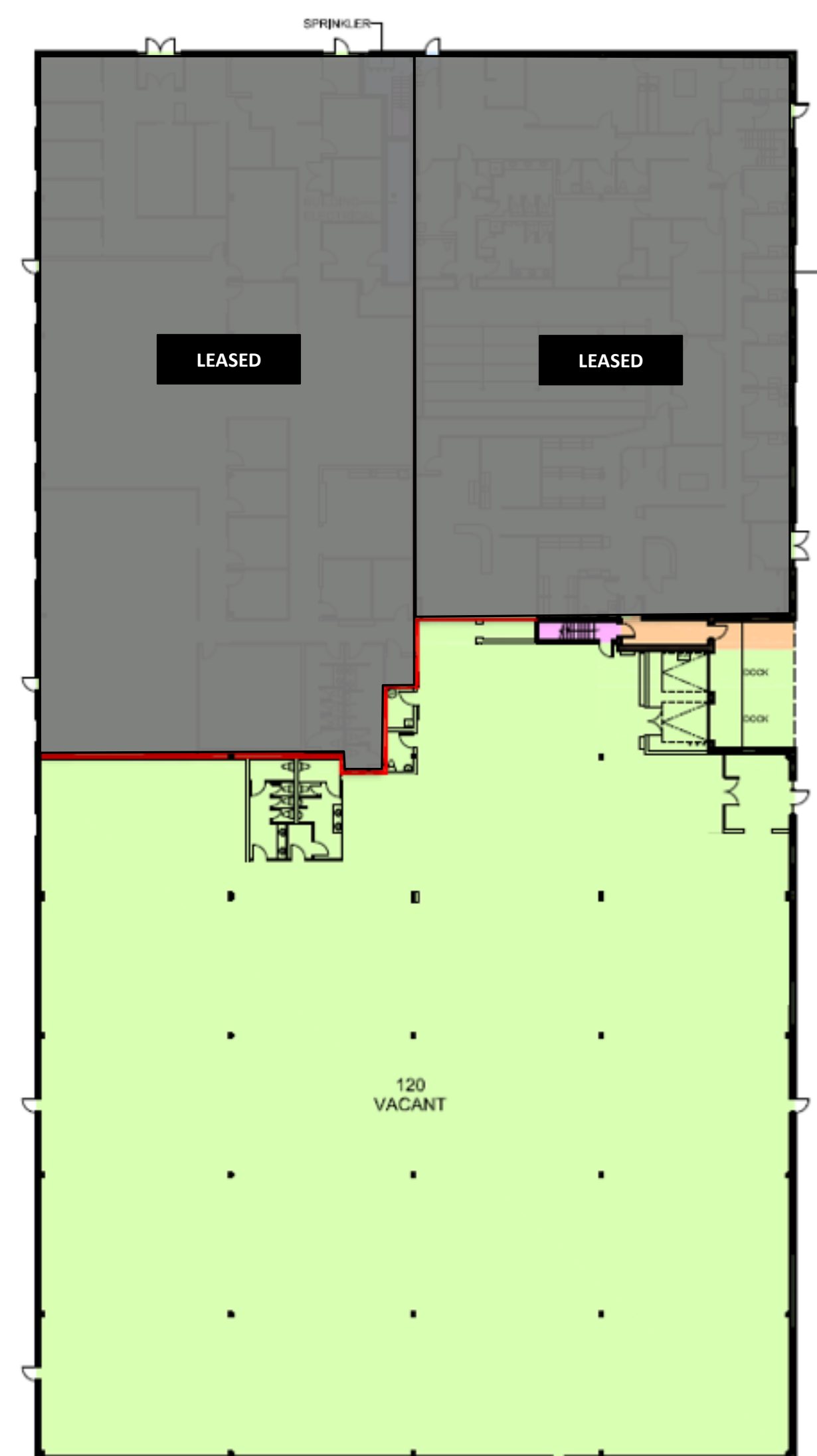

## Keep in touch

**Daniel Niedra, Leasing Manager**

E [daniel\\_niedra@manulife.com](mailto:daniel_niedra@manulife.com)

T 613 369 5567

**Louis-Bernard Bonneau, Leasing Director**

E [louis-bernard\\_bonneau@manulife.com](mailto:louis-bernard_bonneau@manulife.com)

T 613 238 6599