



The Collective  
AT CONCOURSE

ELEVATED SPACES  
*enlivened amenities*

[VIEW AVAILABILITIES →](#)





## OUR NEW CORE *commands attention*

The all-new A&B Lobby in Concourse I has quickly become a community space where ideas are generated, conversations are sparked and relationships are nurtured.



### **Network. Collaborate. Relax.**

- Lounge and high-top seating
- Focus rooms with whiteboards
- Seamless WiFi connectivity



### **Our all-new A&B Center**

features tech-equipped conference rooms and private focus areas for meetings large and small.







The Collective  
AT CONCOURSE



When you see the WELL Health-Safety seal at The Collective at Concourse, you can feel confident knowing we are putting your health first.

- Research-driven approach to advancing human health through building design, policies and protocols
- Standards developed by practitioners, public health professionals and building scientists
- Intentional spaces that fuel our bodies, keep us connected and inspire our best work



**The Collective at Concourse  
prioritizes tenant wellbeing.**





# our all new A&B EXPERIENCE

More than our reimagined lobby and conference facilities,  
A&B goes above and beyond to create a familiar and friendly work  
environment that fosters connections and prioritizes tenant safety.



## A&B EVENTS

Virtual events including  
online fitness classes



## A&B MANAGER

Ambassador to the  
workplace experience



## A&B OUTDOOR

Enhanced outdoor area for  
fresh-air meetings, work or leisure

# host

Host is an exclusive mobile  
app that seamlessly connects  
tenants to all A&B amenities  
and services.

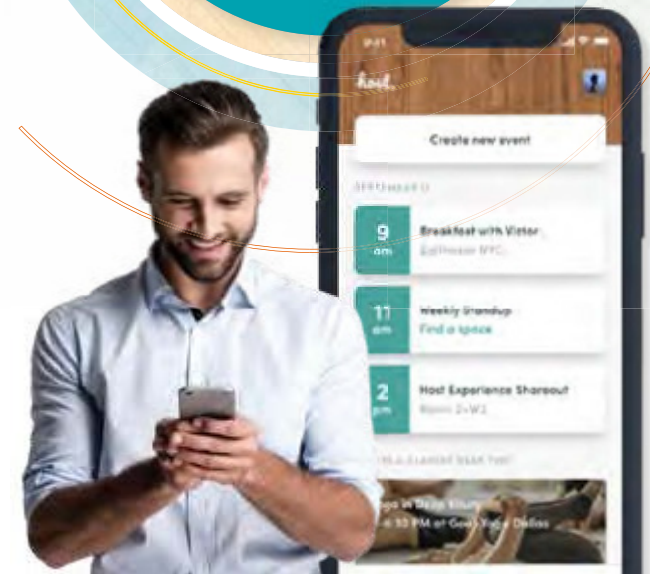

# A WORKPLACE WHERE EMPLOYEES FEEL CONNECTED AND ENGAGED

*most sought-after building amenities by large companies*

LEARN MORE ABOUT A&B →

68%

flexible  
open space

53%

space for private  
calls and meetings

66%

shared  
meeting space

50%

flexible office  
space options

\*CBRE Spring 2022 U.S. Office Occupier Sentiment Survey

SEE FOR YOURSELF  
TAKE A 3D TOUR →

CLICK  
TO PLAY:

*A day at  
The Collective  
at Concourse*





# THE ICONIC, ALL-INCLUSIVE *concourse campus*

The 63-acre, lushly landscaped Concourse campus boasts walk/run trails around a central serene lake and abundant on-campus amenities to attract and retain the best workforce Atlanta has to offer.

## Concourse Perks



### 372-room Westin Conference Hotel

complete with a bar, restaurant,  
conference facilities and  
outdoor pool



### Concourse Coffee Station

for coffee, tea, smoothies  
and fresh to-go food



### Concourse Athletic Club

elevates fitness with its  
full-service, pro-level  
fitness center



### KinderCare

gives children a big boost on  
learning with its educational  
childcare program



### Multiple Dining Options

for lunch on the go or  
a sit-down meal



### PLUS...

Salon services, auto  
detailing and more

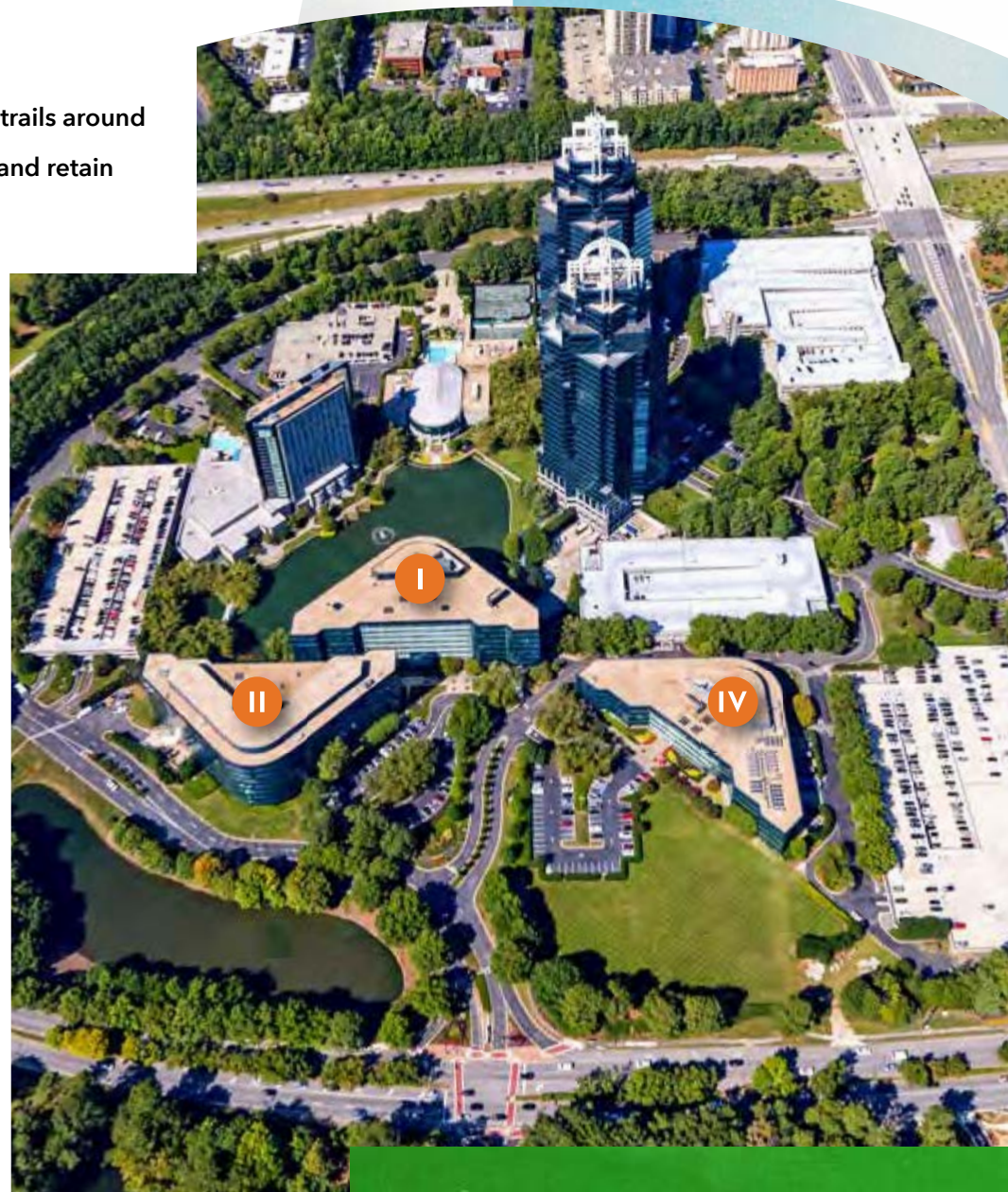

OUR LARGE SPACES

*break boundaries*

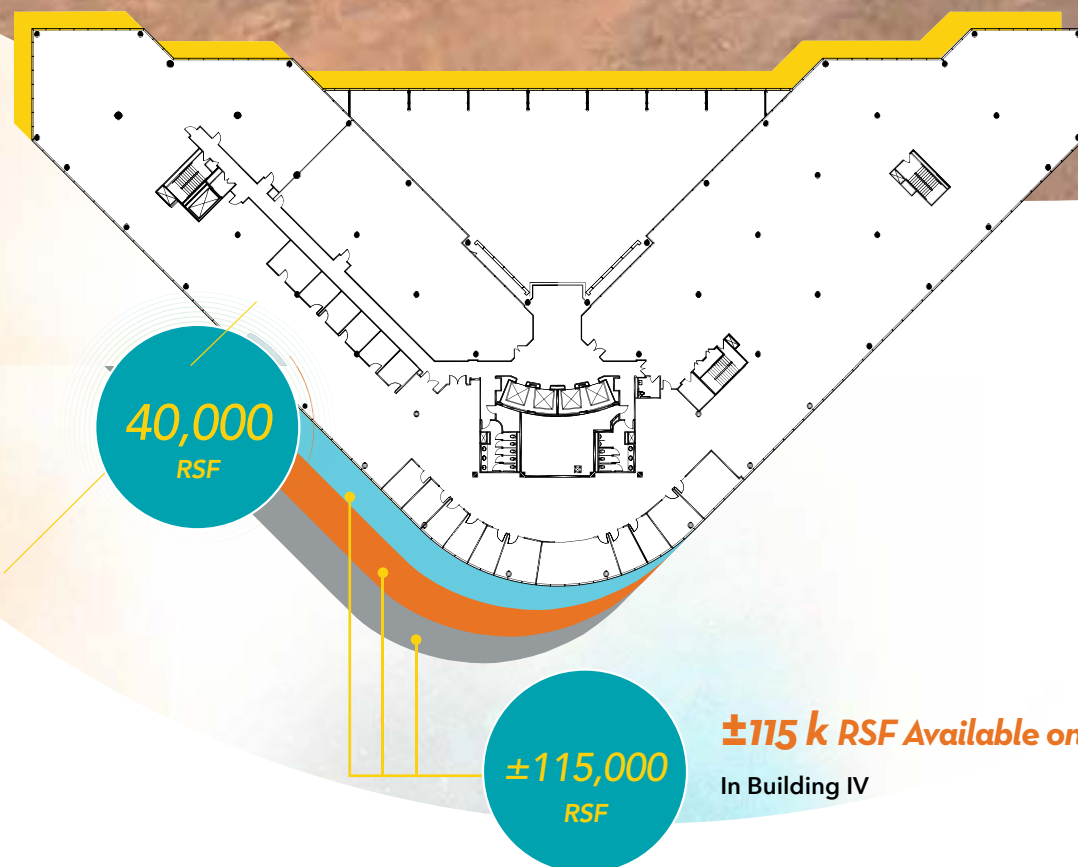

### **Big Blocks**

Create your own modern office with a large block of customizable space.

- 40,000 RSF floor plates
- Floor-to-ceiling windows for abundant natural light
- Large, efficient floor plate for various workspace configurations

**±115 k RSF Available on Contiguous Floors**

In Building IV



## OUR TURNKEY SUITE

# *boosts productivity*

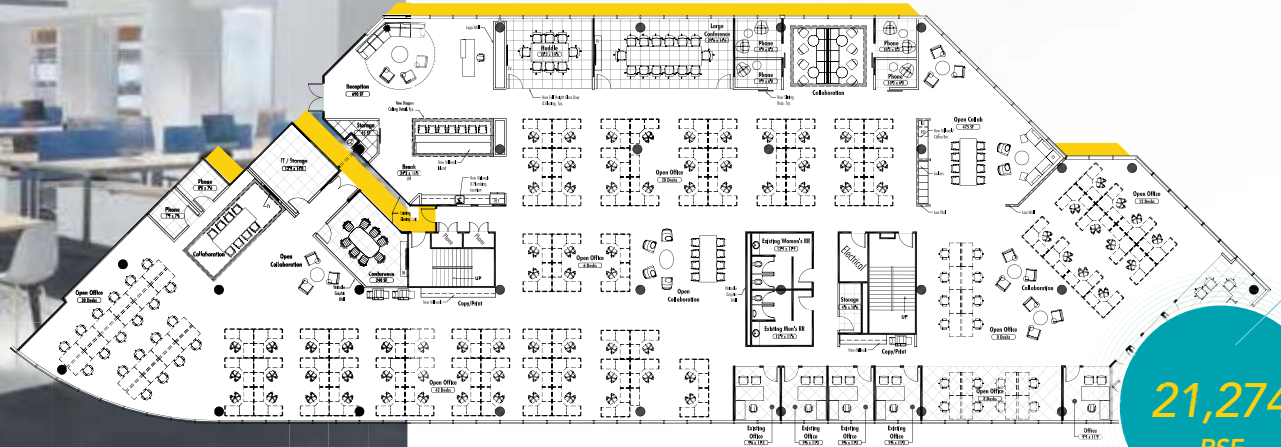

**21,274**  
RSF

### **Spec Suite: Suite 300**

A thoughtfully designed, full-floor spec suite in Concourse IV.

- 21,274 RSF of turnkey space
- 123 workstations, 7 private offices, 4 conference rooms and 6 phone rooms
- Spacious break room and reception area
- Great views of the lush Concourse campus

**DOWNLOAD PDF →**

click to view  
**VIRTUAL  
WALKTHROUGH**







The Collective  
AT CONCOURSE

# THE DETAILS *about our campus*

## *building specifications*

---

**Building:** The Collective at Concourse

**Address:** 1, 2 & 4 Concourse Parkway

**Stories:** 8 (Concourse I);  
8 (Concourse II); 4 (Concourse IV)

**Total Square Footage:** 291,034 RSF (Concourse I);  
292,614 RSF (Concourse II);  
167,445 RSF (Concourse IV)

**Years Built/Renovated:** 1984/2016/2018

**Average Floor Plate:** 40,000 SF

**Parking:** 3.0/1,000

**Submarket:** Central Perimeter | Atlanta, GA

**Owner:** CBRE Investment Management

**Leasing & Property Management:** CBRE





# YOU WANT TO SEE MORE, RIGHT?

*tour our A&B spaces, the concourse campus and more*



[VIEW AVAILABILITIES →](#)



## JEFF KEPPEM

Executive Vice President  
+1 404 504 7923  
[jeff.keppen@cbre.com](mailto:jeff.keppen@cbre.com)

## NICOLE GOLDSMITH

Senior Vice President  
+1 404 923 1254  
[nicole.goldsmith@cbre.com](mailto:nicole.goldsmith@cbre.com)



1, 2 & 4 Concourse Parkway | Atlanta, GA 30328

[www.collectiveatconcourse.com](http://www.collectiveatconcourse.com) | [www.AboveandBeyondforBusiness.com](http://www.AboveandBeyondforBusiness.com)

© 2022 CBRE, Inc. All rights reserved. This information has been obtained from sources believed reliable, but has not been verified for accuracy or completeness. Any projections, opinions, or estimates are subject to uncertainty. The information may not represent the current or future performance of the property. You and your advisors should conduct a careful, independent investigation of the property and verify all information. Any reliance on this information is solely at your own risk. CBRE and the CBRE logo are service marks of CBRE, Inc. and/or its affiliated or related companies in the United States and other countries. All other marks displayed on this document are the property of their respective owners. Photos herein are the property of their respective owners and use of these images without the express written consent of the owner is prohibited.